

chassistype	voorveer									achterveer					hulpveer				
						veerstroppen			toren- bout										
	A	L	B	H	P	d	L	UNF 2A	L	A	L	B	H	P	A	L	B	H	P
A 1100	7	1245	80	64	70	5/8"	150	5/8" x 18	80	14	1345	80	128	100	5	1050	80	44	40
	7	49.01"	3.14"	2.52"	2.76"	5/8"	5.91"	5/8" x 18	3.14"	14	52.95"	3.14"	5.04"	3.89"	5	41.34"	3.14"	1.73"	1.58"
B 1100	9	1245	80	67	75	5/8"	150	5/8" x 18	80	13	1500	80	130	0	—	—	—	—	—
	9	49.01"	3.14"	2.67"	2.95"	5/8"	5.91"	5/8" x 18	3.14"	13	59.05"	3.14"	5.12"	.00"	—	—	—	—	—
A 13	7	1245	80	70	70	5/8"	165	5/8" x 18	90	15	1345	80	144	100	7	1050	80	62	40
	7	49.01"	3.14"	2.76"	2.76"	5/8"	6.49"	5/8" x 18	3.54"	15	52.95"	3.14"	5.67"	3.89"	7	41.34"	3.14"	2.44"	1.58"
T 13	8	1245	80	72	70	5/8"	165	5/8" x 18	90	13	1345	80	124	100	7	1050	80	62	40
	8	49.01"	3.14"	2.84"	2.76"	5/8"	6.49"	5/8" x 18	3.54"	13	52.95"	3.14"	4.88"	3.89"	7	41.34"	3.14"	2.44"	1.58"
A 1300	10	1245	80	100	70	3/4"	175	3/4" x 16	120	13	1345	80	124	100	7	1050	80	62	40
	10	49.01"	3.14"	3.89"	2.76"	3/4"	6.89"	3/4" x 16	4.73"	13	52.95"	3.14"	4.88"	3.89"	7	41.34"	3.14"	2.44"	1.58"
T 1300	8	1245	80	70	70	5/8"	150	5/8" x 18	90	13	1345	80	124	100	7	1050	80	62	40
	8	49.01"	3.14"	2.76"	2.76"	5/8"	5.91"	5/8" x 18	3.54"	13	52.95"	3.14"	4.88"	3.89"	7	41.34"	3.14"	2.44"	1.58"
B 1300	13	1200	80	107	20	3/4"	195	3/4" x 16	120	15	1500	80	150	0	—	—	—	—	—
	13	47.24"	3.14"	4.21"	.79"	3/4"	7.68"	3/4" x 16	4.73"	15	59.05"	3.14"	5.91"	.00"	—	—	—	—	—
G 1300	11	1245	80	104	70	3/4"	175	3/4" x 16	120	13	1345	80	124	100	7	1050	80	62	40
	11	49.01"	3.14"	4.09"	2.76"	3/4"	6.89"	3/4" x 16	4.73"	13	52.95"	3.14"	4.88"	3.89"	7	41.34"	3.14"	2.44"	1.58"
T 1502	9	1245	80	84	70	3/4"	175	3/4" x 16	100	13	1345	80	124	100	7	1050	80	70	40
	9	49.01"	3.14"	3.31"	2.76"	3/4"	6.89"	3/4" x 16	3.89"	13	52.95"	3.14"	4.88"	3.89"	7	41.34"	3.14"	2.76"	1.58"
T 15/2	8	1245	80	72	70	5/8"	165	5/8" x 18	90	13	1345	80	124	100	7	1050	80	70	40
	8	49.01"	3.14"	2.84"	2.76"	5/8"	6.49"	5/8" x 18	3.54"	13	52.95"	3.14"	4.88"	3.89"	7	41.34"	3.14"	2.76"	1.58"
A 1600 DA	10	1245	80	100	70	3/4"	175	3/4" x 16	120	13	1345	80	116	100	7	1050	80	70	40
	10	49.01"	3.14"	3.89"	2.76"	3/4"	6.89"	3/4" x 16	4.73"	13	52.95"	3.14"	4.57"	3.89"	7	41.34"	3.14"	2.76"	1.58"
A 1600 DD-BB	11	1245	80	104	70	3/4"	175	3/4" x 16	120	13	1345	80	116	100	7	1050	80	70	40
	11	49.01"	3.14"	4.09"	2.76"	3/4"	6.89"	3/4" x 16	4.73"	13	52.95"	3.14"	4.57"	3.89"	7	41.34"	3.14"	2.76"	1.58"
B 1600	14	1200	80	114	20	3/4"	195	3/4" x 16	130	11	1600	90	121	30	holle rubberveer				
	14	47.24"	3.14"	4.49"	.79"	3/4"	7.68"	3/4" x 16	5.12"	11	62.99"	3.54"	4.76"	1.18"	holle rubberveer				
G 1600	11	1245	80	104	70	3/4"	175	3/4" x 16	120	13	1345	80	116	100	7	1050	80	70	40
	11	49.01"	3.14"	4.09"	2.76"	3/4"	6.89"	3/4" x 16	4.73"	13	52.95"	3.14"	4.57"	3.89"	7	41.34"	3.14"	2.76"	1.58"
V 1600	9	1245	80	84	70	3/4"	290	3/4" x 16	100	13	1345	80	116	100	7	1050	80	70	40
	9	49.01"	3.14"	3.31"	2.76"	3/4"	11.46"	3/4" x 16	3.89"	13	52.95"	3.14"	4.57"	3.89"	7	41.34"	3.14"	2.76"	1.58"
A 1602 (L)	12	1300	80	120	80	3/4"	180	3/4" x 16	140	17	1345	80	162	100	8	1050	80	80	40
	12	51.18"	3.14"	4.73"	3.14"	3/4"	7.09"	3/4" x 16	5.51"	17	52.95"	3.14"	6.38"	3.89"	8	41.34"	3.14"	3.14"	1.58"

achterveer				hulpveer					veerstroppen			toren- bout
L	B	H	P	A	L	B	H	P	d	L	UNF 2A	L
1345 2.95"	80 3.14"	128 5.04"	100 3.89"	5 5	1050 41.34"	80 3.14"	44 1.73"	40 1.58"	3/4" 3/4"	420 16.54"	3/4" x 16 3/4" x 16	190 7.48"
1500 9.05"	80 3.14"	130 5.12"	0 .00"	— —	— —	— —	— —	— —	5/8" 5/8"	300 11.81"	5/8" x 18 5/8" x 18	150 5.91"
1345 2.95"	80 3.14"	144 5.67"	100 3.89"	7 7	1050 41.34"	80 3.14"	62 2.44"	40 1.58"	7/8" 7/8"	390 15.35"	7/8" x 14 7/8" x 14	220 8.65"
1345 2.95"	80 3.14"	124 4.88"	100 3.89"	7 7	1050 41.34"	80 3.14"	62 2.44"	40 1.58"	3/4" 3/4"	375 14.76"	3/4" x 16 3/4" x 16	200 7.87"
1345 2.95"	80 3.14"	124 4.88"	100 3.89"	7 7	1050 41.34"	80 3.14"	62 2.44"	40 1.58"	3/4" 3/4"	430 16.93"	3/4" x 16 3/4" x 16	200 7.87"
1345 2.95"	80 3.14"	124 4.88"	100 3.89"	7 7	1050 41.34"	80 3.14"	62 2.44"	40 1.58"	3/4" 3/4"	375 14.76"	3/4" x 16 3/4" x 16	200 7.87"
1500 9.05"	80 3.14"	150 5.91"	0 .00"	— —	— —	— —	— —	— —	7/8" 7/8"	340 13.36"	7/8" x 14 7/8" x 14	170 6.69"
1345 2.95"	80 3.14"	124 4.88"	100 3.89"	7 7	1050 41.34"	80 3.14"	62 2.44"	40 1.58"	3/4" 3/4"	430 16.93"	3/4" x 16 3/4" x 16	200 7.87"
1345 2.95"	80 3.14"	124 4.88"	100 3.89"	7 7	1050 41.34"	80 3.14"	70 2.76"	40 1.58"	7/8" 7/8"	450 17.72"	7/8" x 14 7/8" x 14	210 8.27"
1345 2.95"	80 3.14"	124 4.88"	100 3.89"	7 7	1050 41.34"	80 3.14"	70 2.76"	40 1.58"	7/8" 7/8"	450 17.72"	7/8" x 14 7/8" x 14	210 8.27"
1345 2.95"	80 3.14"	116 4.57"	100 3.89"	7 7	1050 41.34"	80 3.14"	70 2.76"	40 1.58"	7/8" 7/8"	450 17.72"	7/8" x 14 7/8" x 14	200 7.87"
1345 2.95"	80 3.14"	116 4.57"	100 3.89"	7 7	1050 41.34"	80 3.14"	70 2.76"	40 1.58"	7/8" 7/8"	450 17.72"	7/8" x 14 7/8" x 14	200 7.87"
1600 2.99"	90 3.54"	121 4.76"	30 1.18"	holle rubberveer holle rubberveer					7/8" 7/8"	330 12.99"	7/8" x 14 7/8" x 14	140 5.51"
1345 2.95"	80 3.14"	116 4.57"	100 3.89"	7 7	1050 41.34"	80 3.14"	70 2.76"	40 1.58"	7/8" 7/8"	450 17.72"	7/8" x 14 7/8" x 14	200 7.87"
1345 2.95"	80 3.14"	116 4.57"	100 3.89"	7 7	1050 41.34"	80 3.14"	70 2.76"	40 1.58"	7/8" 7/8"	450 17.72"	7/8" x 14 7/8" x 14	200 7.87"
1345 2.95"	80 3.14"	162 6.38"	100 3.89"	8 8	1050 41.34"	80 3.14"	80 3.14"	40 1.58"	7/8" 7/8"	490 19.29"	7/8" x 14 7/8" x 14	260 10.24"

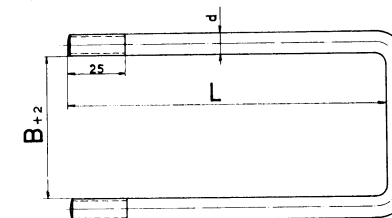
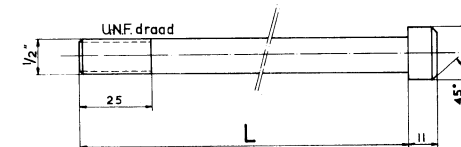
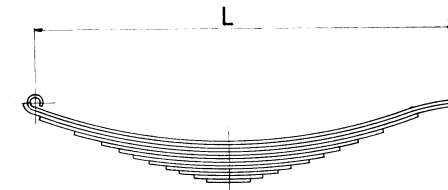
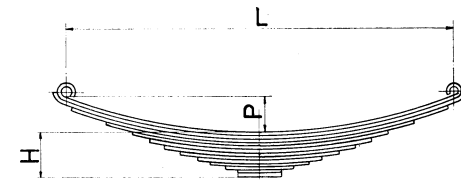

03.C038

AANHAALKOPPELS

ft.lb.

ft.lb.

A 1602 (L)	12	1300	80	120	80	3/4"	180	3/4" x 16	140	17	1345	80	162	100	8	1050	80	3
	12	51.18"	3.14"	4.73"	3.14"	3/4"	7.09"	3/4" x 16	5.51"	17	52.95"	3.14"	6.38"	3.89"	8	41.34"	3.14"	
(R)	12	1300	80	120	80	3/4"	180	3/4" x 16	140	15	1345	80	142	100	8	1050	80	3
	12	51.18"	3.14"	4.73"	3.14"	3/4"	7.09"	3/4" x 16	5.51"	15	52.95"	3.14"	5.60"	3.89"	8	41.34"	3.14"	
A 16 DA	7	1245	80	70	70	5/8"	165	5/8" x 18	90	14	1345	80	126	100	7	1050	80	2
	7	49.01"	3.14"	2.76"	2.76"	5/8"	6.49"	5/8" x 18	3.54"	14	52.95"	3.14"	4.96"	3.89"	7	41.34"	3.14"	
A 16 DD-BB	9	1245	80	84	70	3/4"	175	3/4" x 16	100	14	1345	80	126	100	7	1050	80	2
	9	49.01"	3.14"	3.31"	2.76"	3/4"	6.89"	3/4" x 16	3.89"	14	52.95"	3.14"	4.96"	3.89"	7	41.34"	3.14"	
A 1800	11	1245	80	104	70	3/4"	175	3/4" x 16	120	12	1560	100	140	90	8	1150	100	3
	11	49.01"	3.14"	4.09"	2.76"	3/4"	6.89"	3/4" x 16	4.73"	12	61.41"	3.89"	5.51"	3.54"	8	45.28"	3.89"	
T 1800	8	1700	80	96	95	3/4"	175	3/4" x 16	110	10	1560	100	120	90	8	1150	100	3
	8	66.93"	3.14"	3.78"	3.74"	3/4"	6.89"	3/4" x 16	4.33"	10	61.41"	3.89"	4.73"	3.54"	8	45.28"	3.89"	
A 1900DS-DD	12	1300	80	120	80	3/4"	190/220	3/4" x 16	140	12	1560	100	140	90	8	1150	100	3
	12	51.18"	3.14"	4.73"	3.14"	3/4"	7.48"/8.66"	3/4" x 16	5.51"	12	61.41"	3.89"	5.51"	3.54"	8	45.28"	3.89"	
A 2000 DO	12	1300	80	120	80	3/4"	205	3/4" x 16	140	10	1560	100	120	90	8	1150	100	3
	12	51.18"	3.14"	4.73"	3.14"	3/4"	8.07"	3/4" x 16	5.51"	10	61.41"	3.89"	4.73"	3.54"	8	45.28"	3.89"	
T 2000 DO	12	1300	80	120	80	3/4"	205	3/4" x 16	140	10	1560	100	120	90	8	1150	100	3
	12	51.18"	3.14"	4.73"	3.14"	3/4"	8.07"	3/4" x 16	5.51"	10	61.41"	3.89"	4.73"	3.54"	8	45.28"	3.89"	
T 2000 DO (lichte achterveer)	12	1300	80	120	80	3/4"	205	3/4" x 16	140	9	1560	100	108	100	8	1150	100	3
	12	51.18"	3.14"	4.73"	3.14"	3/4"	8.07"	3/4" x 16	5.51"	9	61.41"	3.89"	4.25"	3.89"	8	45.28"	3.89"	
AS 2000 DO	12	1300	80	120	80	3/4"	205	3/4" x 16	140	10	1560	100	120	90	8	1150	100	3
	12	51.18"	3.14"	4.73"	3.14"	3/4"	8.07"	3/4" x 16	5.51"	10	61.41"	3.89"	4.73"	3.54"	8	45.28"	3.89"	
A 2600 DP	11	1600	100	132	90	7/8"	220	7/8" x 14	150	14	1675	100	166	90	9	1150	100	3
	11	62.99"	3.89"	5.20"	3.54"	7/8"	8.66"	7/8" x 14	5.91"	14	65.94"	3.89"	6.54"	3.54"	9	45.28"	3.89"	
AE 2600 DP	11	1600	100	132	90	7/8"	220	7/8" x 14	150	15	1675	100	180	90	9	1150	100	3
	11	62.99"	3.89"	5.20"	3.54"	7/8"	8.66"	7/8" x 14	5.91"	15	65.94"	3.89"	7.09"	3.54"	9	45.28"	3.89"	
T 2600 DP	11	1600	100	132	90	7/8"	220	7/8" x 14	150	14	1675	100	164	90	—	—	—	—
	11	62.99"	3.89"	5.20"	3.54"	7/8"	8.66"	7/8" x 14	5.91"	14	65.94"	3.89"	6.46"	3.54"	—	—	—	
A 3200	11	1245	80	104	70	3/4"	175	3/4" x 16	120	21	1420	80	252	0	—	—	—	—
	11	49.01"	3.14"	4.09"	2.76"	3/4"	6.89"	3/4" x 16	4.73"	21	55.90"	3.14"	9.92"	.00"	—	—	—	
TB 102 (A-weg)	11	1600	90	121	30	3/4"	190	3/4" x 16	140	10	1600	90	110	30	—	—	holle rubber	—
	11	62.99"	3.54"	4.76"	1.18"	3/4"	7.48"	3/4" x 16	5.51"	10	62.99"	3.54"	4.33"	1.18"	—	—	holle rubber	
TB 102 (B-weg)	11	1600	90	121	30	3/4"	190	3/4" x 16	140	10	1600	90	110	30	—	—	—	—
	11	62.99"	3.54"	4.76"	1.18"	3/4"	7.48"	3/4" x 16	5.51"	10	62.99"	3.54"	4.33"	1.18"	—	—	—	
TB 160	11	1600	90	121	30	3/4"	190	3/4" x 16	140	11	1600	90	121	30	—	—	holle rubber	—
	11	62.99"	3.54"	4.76"	1.18"	3/4"	7.48"	3/4" x 16	5.51"	11	62.99"	3.54"	4.76"	1.18"	—	—	holle rubber	

												AANHAALKOPPELS						
1345	80	162	100	8	1050	80	80	40	7/8"	490	7/8" x 14	260						
2.95"	3.14"	6.38"	3.89"	8	41.34"	3.14"	3.14"	1.58"	7/8"	19.29"	7/8" x 14	10.24"						
1345	80	142	100	8	1050	80	80	40	7/8"	470	7/8" x 14	250						
2.95"	3.14"	5.60"	3.89"	8	41.34"	3.14"	3.14"	1.58"	7/8"	18.50"	7/8" x 14	9.84"	Veerstroppen				mkg	ft.lb.
														5/8"	17—20			123—144
														3/4"	30—35			217—253
1345	80	126	100	7	1050	80	70	40	7/8"	420	7/8" x 14	220						
2.95"	3.14"	4.96"	3.89"	7	41.34"	3.14"	2.76"	1.58"	7/8"	16.54"	7/8" x 14	8.66"						
														7/8"	45—52			326—376
														1"	65—75			471—542
1345	80	126	100	7	1050	80	70	40	7/8"	420	7/8" x 14	220						
2.95"	3.14"	4.96"	3.89"	7	41.34"	3.14"	2.76"	1.58"	7/8"	16.54"	7/8" x 14	8.66"	Torenbout					
														1/2"	12—15			87—108
1560	100	140	90	8	1150	100	82	50	1"	460	1" x 14NF	250						
1.41"	3.89"	5.51"	3.54"	8	45.28"	3.89"	3.23"	1.97"	1"	18.11"	1" x 14NF	9.89"	Veerbout					
														1"	10—12			72—85
1560	100	120	90	8	1150	100	82	50	1"	420	1" x 14NF	220						
1.41"	3.89"	4.73"	3.54"	8	45.28"	3.89"	3.23"	1.97"	1"	16.54"	1" x 14NF	8.66"	Schokbrekermoeren					
															14—16			102—115
1560	100	140	90	8	1150	100	82	50	1"	460	1" x 14	250						
1.41"	3.89"	5.51"	3.54"	8	45.28"	3.89"	3.23"	1.97"	1"	18.11"	1" x 14	9.84"						
1560	100	120	90	8	1150	100	82	50	1"	440	1" x 14NF	220						
1.41"	3.89"	4.73"	3.54"	8	45.28"	3.89"	3.23"	1.97"	1"	17.32"	1" x 14NF	8.66"						
1560	100	120	90	8	1150	100	82	50	1"	440	1" x 14NF	220						
1.41"	3.89"	4.73"	3.54"	8	45.28"	3.89"	3.23"	1.97"	1"	17.32"	1" x 14NF	8.66"						
1560	100	108	100	8	1150	100	82	50	1"	400	1" x 14NF	200						
1.41"	3.89"	4.25"	3.89"	8	45.28"	3.89"	3.23"	1.97"	1"	15.75"	1" x 14NF	7.87"						
1560	100	120	90	8	1150	100	82	50	1"	420	1" x 14NF	220						
1.41"	3.89"	4.73"	3.54"	8	45.28"	3.89"	3.23"	1.97"	1"	16.54"	1" x 14NF	8.66"						
1675	100	166	90	9	1150	100	90	50	1"	490	1" x 14NF	280						
5.94"	3.89"	6.54"	3.54"	9	45.28"	3.89"	3.54"	1.97"	1"	19.29"	1" x 14NF	11.02"						
1675	100	180	90	9	1150	100	90	50	1"	520	1" x 14NF	280						
5.94"	3.89"	7.09"	3.54"	9	45.28"	3.89"	3.54"	1.97"	1"	20.47"	1" x 14NF	11.02"						
1675	100	164	90	—	—	—	—	—	1"	380	1" x 14NF	180						
5.94"	3.89"	6.46"	3.54"	—	—	—	—	—	1"	14.96"	1" x 14NF	7.09"						
1420	80	252	0	—	—	—	—	—	1"	414	1" x 14NF	280						
5.90"	3.14"	9.92"	.00"	—	—	—	—	—	1"	16.29"	1" x 14NF	11.02"						
1600	90	110	30		holle rubberveer				7/8"	315	7/8" x 14	130						
2.99"	3.54"	4.33"	1.18"		holle rubberveer				7/8"	12.50"	7/8" x 14	5.12"						
1600	90	110	30	—	—	—	—	—	7/8"	315	7/8" x 14	130						
2.99"	3.54"	4.33"	1.18"	—	—	—	—	—	7/8"	12.50"	7/8" x 14	5.12"						
1600	90	121	30		holle rubberveer				7/8"	330	7/8" x 14	140						
2.99"	3.54"	4.76"	1.18"		holle rubberveer				7/8"	12.99"	7/8" x 14	5.51"						